

REV	DESCRIPTION	MARK
XI	First edition	

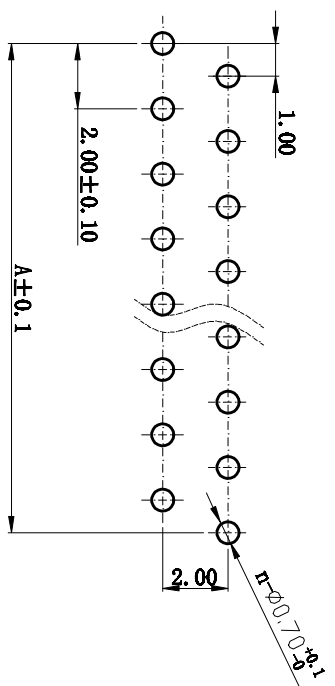
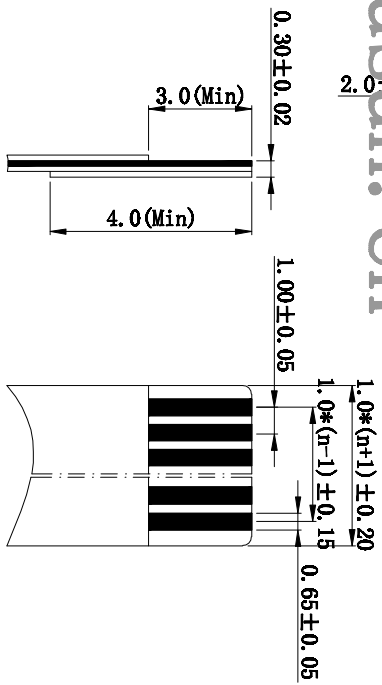
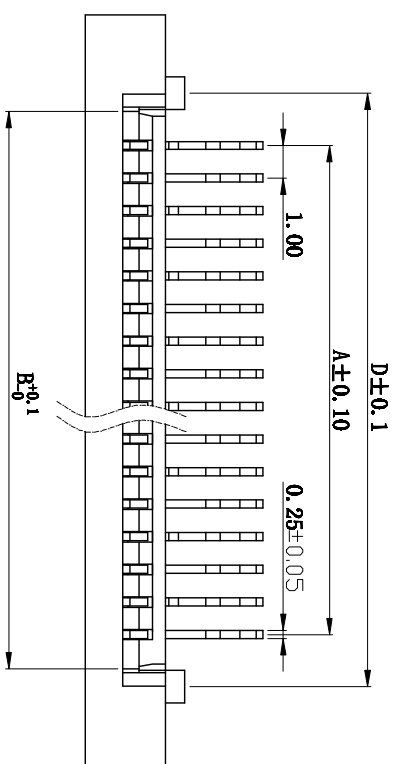
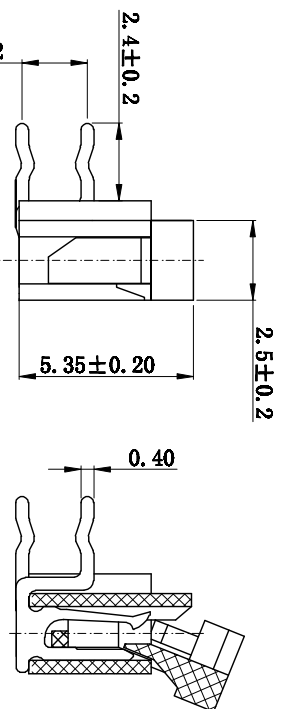
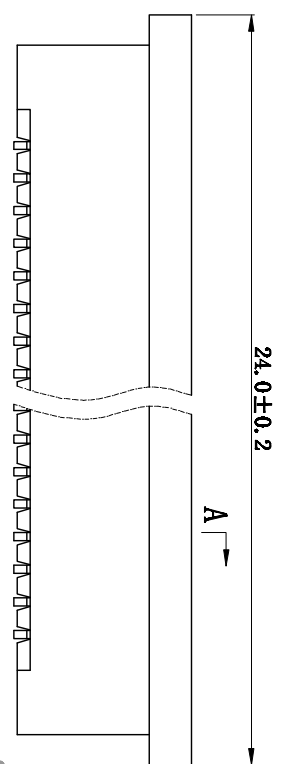

性能:
 额定电流: 0.5A
 额定电压: 50V
 耐电压: 500V
 接触电阻: 30mΩ
 绝缘电阻: 500MΩ
 工作温度: -20℃~+85℃
 绝缘(材质): LCP, U94V-0
 基板(材质): LCP, U94V-0
 封装(材质): 陶瓷, 玻璃
 焊片(材质): 铜膏, 玻璃

孔位	A	B	C	D
4	3.00	5.10	11.00	6.20
5	4.00	6.10	12.00	7.20
6	5.00	7.10	13.00	8.20
7	6.00	8.10	14.00	9.20
8	7.00	9.10	15.00	10.20
9	8.00	10.10	16.00	11.20
10	9.00	11.10	17.00	12.20
11	10.00	12.10	18.00	13.20
12	11.00	13.10	19.00	14.20
13	12.00	14.10	20.00	15.20
14	13.00	15.10	21.00	16.20
15	14.00	16.10	22.00	17.20
16	15.00	17.10	23.00	18.20
17	16.00	18.10	24.00	19.20
18	17.00	19.10	25.00	20.20
19	18.00	20.10	26.00	21.20
20	19.00	21.10	27.00	22.20
21	20.00	22.10	28.00	23.20
22	21.00	23.10	29.00	24.20
23	22.00	24.10	30.00	25.20
24	23.00	25.10	31.00	26.20
25	24.00	26.10	32.00	27.20
26	25.00	27.10	33.00	28.20
27	26.00	28.10	34.00	29.20
28	27.00	29.10	35.00	30.20
29	28.00	30.10	36.00	31.20
30	29.00	31.10	37.00	32.20
31	30.00	32.10	38.00	33.20
32	31.00	33.10	39.00	34.20
33	32.00	34.10	40.00	35.20
34	33.00	35.10	41.00	36.20
35	34.00	36.10	42.00	37.20

JUSUN 钜赛实业(深圳)有限公司
 JUSAI INDUSTRIAL (SHENZHEN) CO.,LTD

PART NO.: 1.0S-12X-nPW
 CIS PART NO.:

DATE: 2016.08.12
 VERSION: VT.0

印制电路板 $\phi=0.8\sim 1.6$

