

技术参数 SPECIFICATIONS

- ◆ 间距: 6.2 Pitch: 6.2
- ◆ 适用线规: AWG#24~#14  
Applicable Wire: AWG#24~#14
- ◆ 额定电压: AC,DC,300V(有效值)  
Voltage rating: AC,DC,300V(rms)
- ◆ 额定电流: 10.0A  
Current rating: 10.0A
- ◆ 耐压值: 1500V AC/minute  
Withstand voltage: 1500V AC/minute
- ◆ 工作温度: -25°C~+85°C  
Working Temperature: -25°C~+85°C
- ◆ 绝缘电阻: ≥1000 ohm  
Insulation resistance: ≥1000ohm
- ◆ 接触电阻: ≤0.02 oh  
Contact resistance: ≤0.02 oh

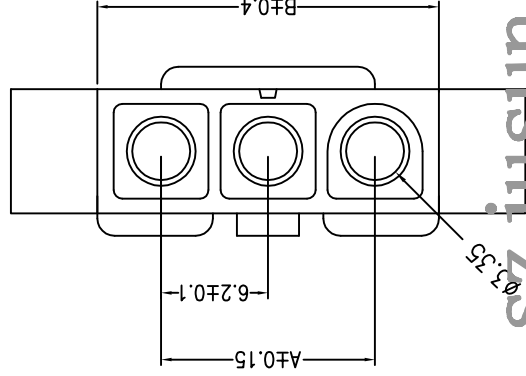

www.szjusun.cn

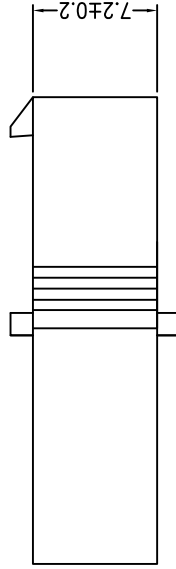

Poles	Part No	Dimensions(mm)	
		A	B
2	L6.2-2A	6.2	13.3
3	L6.2-3A	12.4	19.5

材料 MATERIAL

- ◆ 绝缘座: NY66 UL94V-2  
Housing: NY66 UL94V-2
- ◆ 端子: 磷青铜  
Terminal: Phosphor bronze

GENERAL TOLERANCE		SCALE	1=1	DRAWN	DATE	DWG. NO.
XX. ± 0.40	XXX. ±	UNIT	MM	CHECK	DATE	C:\DWG\Production\L6.2-nA
X. ± 0.25	.XXX ±	SIZE	A4	APPROVE	DATE	PARTS NO.
.X ± 0.15	X' ± 2'					L6.2-nA
.XX ± 0.10	X' ± 1'					

TITLE

塑膠圖

REV.

A

SHEET

1/1