

www.szjusun.cn

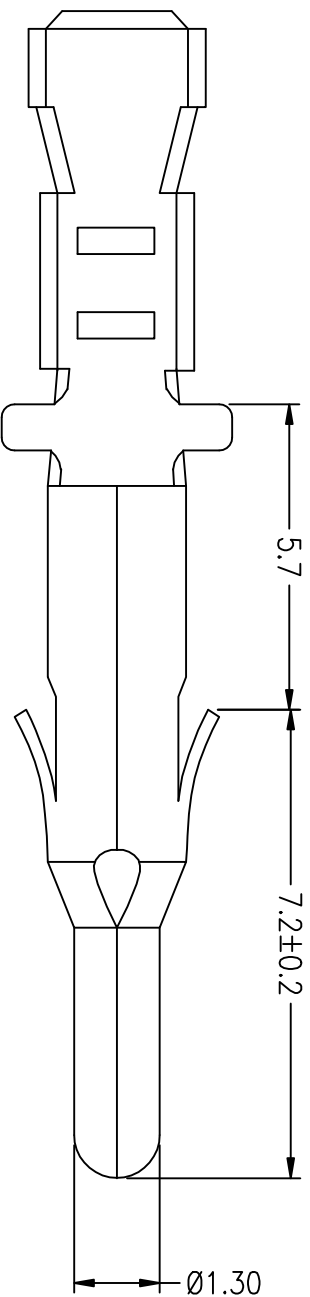

- NOTES:
1. Dim To Be Checked By QC
 2. Along any Portion of strip, Max Allowable Camber is 0.04mm Per 1000mm Length And MAX Allowable Twist is 45° Per 1000mm Length.
 3. All Corners and Radll have a maximum Radius of 0.1mm unless Otherwise Specified.

◆外观检验:

1. 端子刮伤
2. 毛边
3. 歪针变形
4. 电镀颜色

◆打样禁忌:

1. 塑胶裂胶
2. 端子外露, 松动
3. 内八/外八

◆端子料号:

EL-T
端子:T

◆材质: 磷青铜 (Phosphor Bronze C5191R-01)

◆搭配塑胶: EL-nP

 旭升实业(深圳)有限公司 JUSUN INDUSTRIAL (SHENZHEN) CO.,LTD	GENERAL TOLERANCE		SCALE	DRAWN	DATE	DWG. NO.	TITLE	REV.
	XX. ± 0.25	XXX° ± 40°	5=1	CHECK	DATE	G:\DWG\Production\EL-na.DWG	端子图	A
	X. ± 0.20	XX.° ± 10°	MM	APPROVE	DATE	PARTS NO.	EL-T(针座端子)	SHEET
	.X ± 0.15	X.° ± 2°	A4		DATE			1/1
.XX ± 0.08	.X.° ± 1°							